

# LED MINI 360 BEACON, CLASS I

**STAR**  
Safety Technologies by *Grote*



79243



79250



(Pole not included)

## FEATURES & BENEFITS

- Star Generation IV LEDs
- Reliable environmental protection
- Twelve customer selectable flash patterns in either of two phases, plus Steady-On
- S-Link Systems™ synchronizing capabilities with other Star LED units
- Polarity protected
- Polycarbonate lens and base (Ultrasonic welded)
- Three-hole, permanent mount and magnet mount with pattern select cig. plug
- Voltage: 9-32V DC
- Amp draw: 0.4 amps @ 12V DC, 0.2 amps @ 24V DC
- Colors:  **C**
- Approvals: SAE Class I, CA Title13, and IP67 (Amber, Clear, Amber LED Clear Lens)

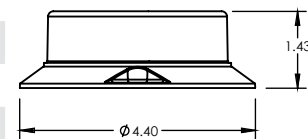
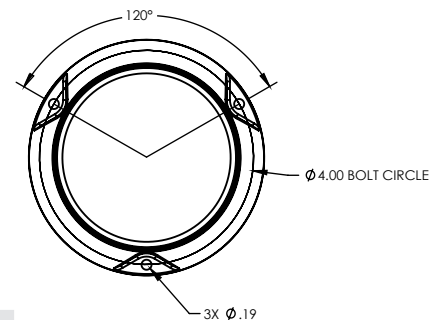

PART	DESCRIPTION
79243	LED Mini 360 Beacon permanent mount, Class I, Amber w/Amber Lens
79240	LED Mini 360 Beacon permanent mount, Class I, Amber w/Clear Lens
79241	LED Mini 360 Beacon permanent mount, Class I, Clear w/Clear Lens
79253	LED Mini 360 Beacon magnet mount, Class I, Amber w/Amber Lens
79250	LED Mini 360 Beacon magnet mount, Class I, Amber w/Clear Lens
79251	LED Mini 360 Beacon magnet mount, Class I, Clear w/Clear Lens
93605	Mirror mount bracket for Mini Beacon

(formerly the 221 series)

**Warning:** Cancer and Reproductive Harm - [www.P65Warnings.ca.gov](http://www.P65Warnings.ca.gov)

SF227 REV B 5-31-24



**FOR MORE INFORMATION  
VISIT OUR WEBSITE.  
STARSAFETYTECHNOLOGIES.COM**

**Star Safety Technologies, LLC**  
455 Rochester St., Avon, NY 14414  
Phone: 585-226-9500 | Fax: 888-478-2797

**STAR**  
Safety Technologies by *Grote*